

SWISSPEARL® FIBER CEMENT RAINSCREEN

West End Square 50

Award-winning Swisspearl® Façade for DC's Squash Capital



[TEN Arquitectos](#) & [WDG Architecture](#) were tasked with designing DC's new West End fire station, along with a 52 affordable dwelling units and a commercial space intended for competitive squash tournaments.

By pairing our [SWISSPEARL®](#) fiber-cement panels with an ECO Cladding [Alpha Hci.10](#) System, this award-winning, LEED Silver project is a stunning example of high-performance rainscreen innovation.

System Type: Alpha Hci.10 System

Panel Type: CARAT Onyx 7099

Architect: TEN Arquitectos & WDG Architecture

Installer: Reliant Drywall

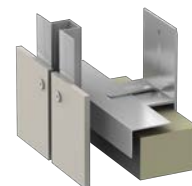

888-826-8453

CLADDING CORP

THE 1ST NAME IN RAINSCREEN

08012019