

PORCELAIN CERAMIC RAINSCREEN

# Templeton Elementary School – Templeton, MA

*A Modern Sustainable School Building for a Rural Community*

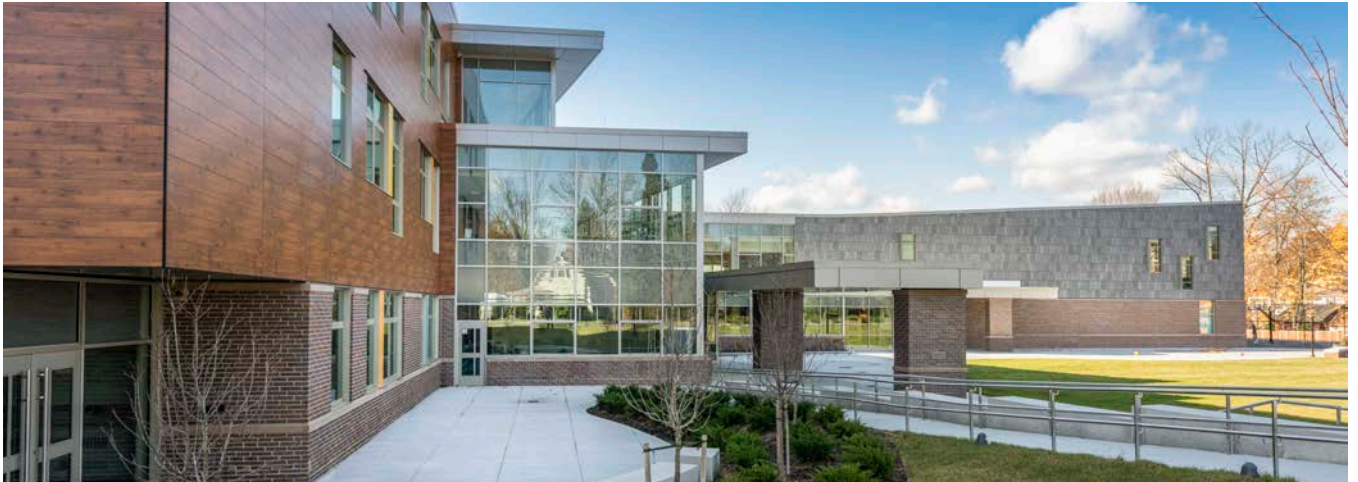

[SMMA Architects](#) was selected to design a master plan for three elementary schools in the Narragansett Regional School District, tasked with designing to provide a next-generation model for education. The new and enhanced footprint of the previous buildings has provided a 21st Century school, a model for educational programming and sustainability. One of the defining features of this project was the use of an energy-efficient Ceramic5 Porcelain Rainscreen facade in the metallic series, for a high-performance, maintenance-free metal panel aesthetic.

Panel Type: [Ceramic5](#)  
[Timber](#)

Architect: SMMA  
Architects

888-826-8453

**CLADDING CORP**

THE 1<sup>ST</sup> NAME IN RAINSCREEN