

## Northeastern University Pedestrian Bridge – Boston, MA

*Upcoming Pedestrian Bridge designed to connect campus and public communities*

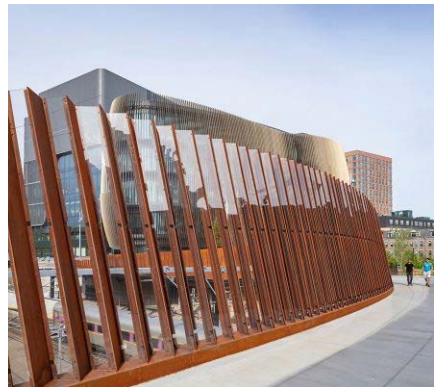

Designed by [Payette](#), the Northeastern University Pedestrian Bridge is planned to connect the main campus with the expanding Interdisciplinary Science and Engineering Complex. One of Payette's design requirements was to incorporate facade materials that would require minimal maintenance. Swisspearl fiber cement panels are colorfast and never have to be painted for the life of the structure. Selecting weathering steel also imbues a reddish-brown patina to the structure which complements the surrounding architecture. Instead of employing the conventional 'curl-over' guard rail fencing typical on bridges that cross railways, the new bridge's steel panels angle outward and grow in height to attain the necessary protection over the catenary wires.

Panels are to be installed using an ECO Cladding Vci.40 concealed aluminum subframing system.

Panel Type: Swisspearl®  
System: [ECO Cladding Vci.40](#)

Architect: Payette

888-826-8453

**CLADDING CORP**

THE 1<sup>ST</sup> NAME IN RAINSCREEN